

### BILL OF MATERIALS

ITEM	QTY	PART NO.	DESCRIPTION
1	1	150-15802WP	Ø1½" DOUBLE BEND 12" WIDE WAND WELDMENT
2	1	V2P-EZ	500PSI BRASS EASY SQUEEZE VALVE
3	1	70364	#10-32 x 1⅛" SS PHILLIPS PAN HEAD MACHINE SCREW
4	2	70858	#10-32 SS NYLOC HEX NUT
5	1	72517	#10-32 x 5/8" PHILLIPS PAN HEAD MACHINE SCREW
6	1	H24	¼" 45° BRASS STREET ELBOW
7	1	AC64V2P	CAST ALUMINUM HANDLE MODIFIED FOR WELD ON
8	1	AC16	Ø1½" x 6" BLACK GRIP SLEEVE
9	1	CFT9	¼" MPT x ¼" TUBE FERRULE FITTING
10	2	H50-9503	¼" BRASS VEE JET
11	1	H44	¼" VEE JET STRAINER
12	1	AC11	Ø1½" PADDED ASSIST HANDLE

REVISIONS		
REV	DESCRIPTION	DATE
A	UPDATED PART NUMBERS	1-13-2011

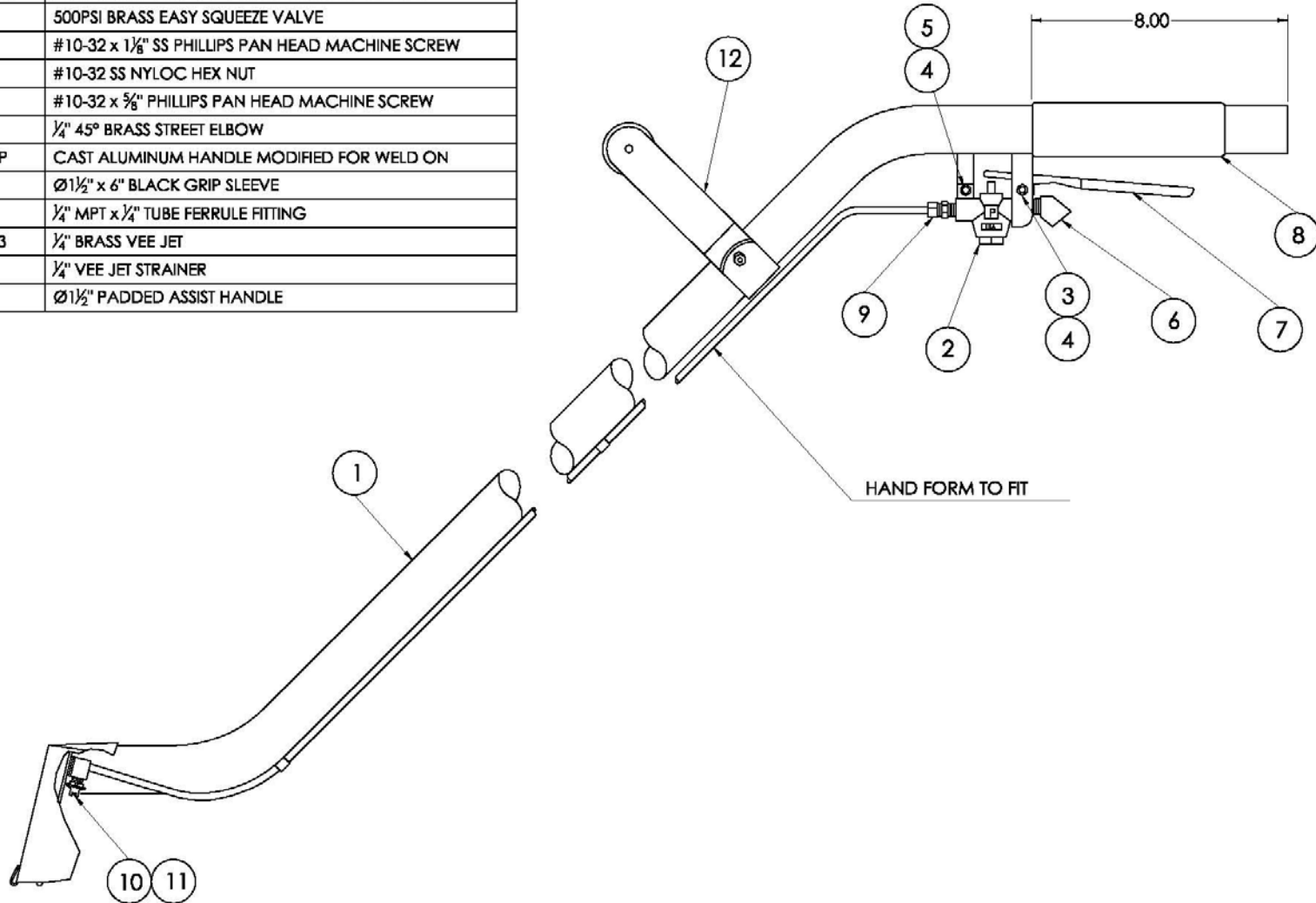

**DEPARTMENTS:**

- ✓ Hose Department
- ✓ Shipping/Assembly
- ✓ Slab
- ✓ Tube Bending/Scotsman
- ✓ Weld



**3485 Twin Jet Wand**